

## Mini free-standing Beacons / Flash Light 215

**Flashing Beacon WM 24VDC YE**

Part No.: 215.300.55

**MECHANICAL DATA**

|                              |                             |
|------------------------------|-----------------------------|
| Height                       | 123 mm                      |
| Diameter                     | 58 mm                       |
| Materials                    | PA-GF<br>PC                 |
| Dome colour                  | Yellow                      |
| Housing colour               | Black                       |
| Protection category          | IP65                        |
| Connection                   | Spring-type terminal        |
| cross-sectional area maximum | 2,50mm <sup>2</sup> / 14AWG |
| Cable entry                  | Screwed cable gland         |
| Cable entry minimum          | d = 3 mm                    |
| Cable entry maximum          | d = 6 mm                    |
| Tension relief               | Present (conforms to VDE)   |
| Type of fixing               | Wall mounting               |
| Working temperature minimum  | -20°C                       |
| Working temperature maximum  | +50°C                       |
| Weight with packaging        | 126 g                       |
| Product weight               | 95 g                        |

**ELECTRICAL DATA**

|                             |                    |
|-----------------------------|--------------------|
| Operating voltage           | 24V                |
| Operating voltage type      | DC                 |
| Operating voltage tolerance | +/- 10%            |
| Rated operational voltage   | 24 VDC             |
| Rated operational current   | 100 mA             |
| Rated inrush current        | 500 mA             |
| Protection class            | Protection class 2 |
| Pollution degree            | 3                  |

**OPTICAL DATA**

|                      |                           |
|----------------------|---------------------------|
| Light source         | Xenon                     |
| Light colour         | Yellow                    |
| Optical signal image | Flash                     |
| Flash frequency      | 0.75 Hz                   |
| Flash output         | 1 J                       |
| Service life optical | 4 million flashes minimum |

**APPROVAL DATA**

|                  |     |
|------------------|-----|
| Conforms with CE | Yes |
|------------------|-----|



For additional installation and mounting information, refer to the appropriate user guide at [www.werma.com](http://www.werma.com). This printed copy is for information only and is subject to alteration.

## Mini free-standing Beacons / Flash Light 215

### Flashing Beacon WM 24VDC YE

|                               |                       |
|-------------------------------|-----------------------|
| Conforms with RoHS directive  | Yes                   |
| WEEE                          | Yes                   |
| Conforms with ATEX-directive  | No                    |
| Conforms with CCC             | No                    |
| Conforms with UL              | cULus                 |
| UL Type Rating                | Type 12               |
| Conforms with FCC             | No                    |
| Conforms with IC              | No                    |
| EAC certificate available     | Yes                   |
| Conforms with UKCA (Importer) | Yes (WERMA (UK) Ltd.) |
| Conforms with AS-I            | No                    |
| ICAO Certification            | No                    |
| Conforms with DNV             | No                    |
| Conforms with RoHS CN         | No                    |
| Conforms with VdS             | No                    |



For additional installation and mounting information, refer to the appropriate user guide at [www.werma.com](http://www.werma.com). This printed copy is for information only and is subject to alteration.

Mini free-standing Beacons / Flash Light 215

## Flashing Beacon WM 24VDC YE

### DRAWING

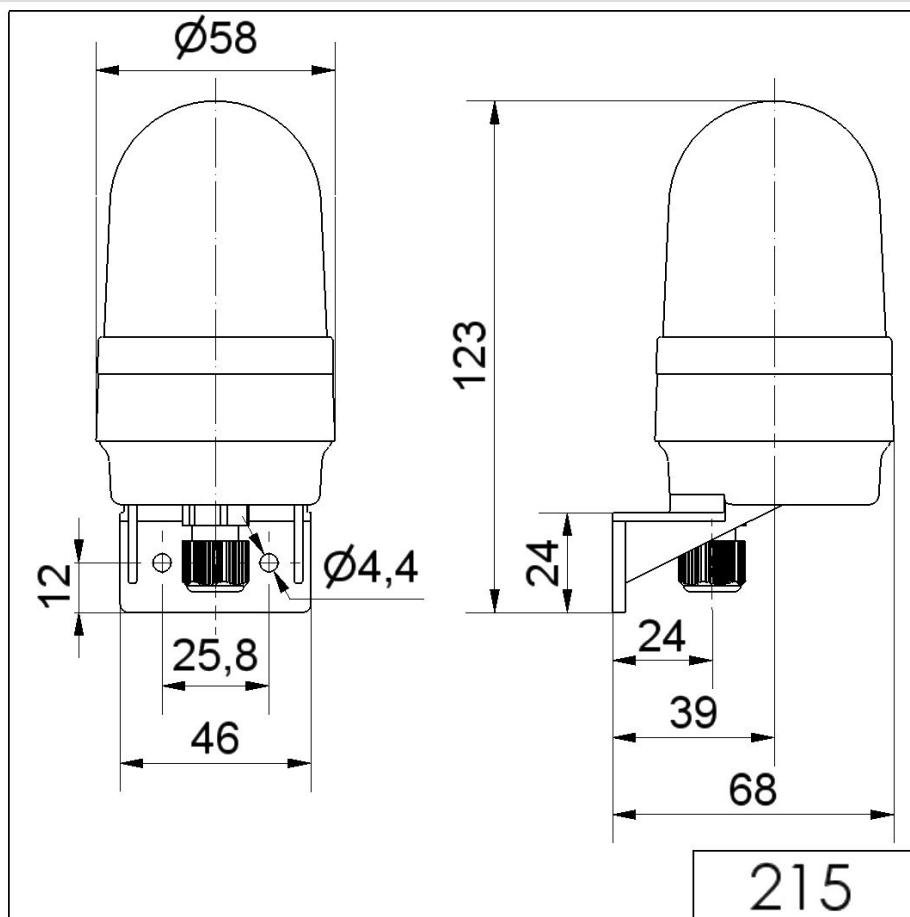

For additional installation and mounting information, refer to the appropriate user guide at [www.werma.com](http://www.werma.com). This printed copy is for information only and is subject to alteration.