

GIRA SOLE MINI

LED | RECESSED LUMINAIRE | WET | IP65



GSMLED

- **OPTICAL LENS:** Optical grade polycarbonate material provides thermal stability and overall system durability.
- **DIFFUSER:** Fully gasketed, tempered glass, recessed lens.
- **HOUSING:** Fabricated from high-strength aluminum alloy with an anodized or hard anodized finish.



APPLICATION: The **GIRA SOLE MINI** is a recessed mount luminaire. Ideal for use in walkways, corridors, stairwells, restaurants and retail.

CONFIGURATIONS

MODEL	LED/PERFORMANCE	DISTRIBUTION	INPUT*	MOUNTING	FINISH
GSMLED	WT35 (3500K)	NBD (narrow 25°)	120V/277V	ID (in drywall)	AB (anodized black)
	WT41 (4100K)	MBD (medium 40°)	24VDC		AC (anodized clear)
	WT57 (5700K)				HAB (hard anodizedblack)
	SCL ¹ (single color LED)				HAT (hard anodizedtitanium)
					CAC (custom anodized color)

NOTE 1: Custom, contact factory.

HOUSING: Gira Sole Mini is constructed from machined aluminum alloy with anodized or hard anodized finish.

OPTICAL LENS: Cluster design for tight pack uniformity of LEDs. High light collection efficiency rating >85%. Optical grade poly carbonate material provides thermal stability and overall system durability.

DIFFUSER: Fully gasketed, tempered glass, recessed lens. Complete light emission clear optics for increased efficiency and performance.

LED LIGHT ENGINE: High performance white LED available in standard color temperatures 3500K (warm), 4100K (daylight), 5700K (cool). RGB color mixing available in 24VDC only. Single color LED offered contact factory.

POWER LINE/FEED: Single color LED fixture uses a 36" long black two wire cord, and RGB LED fixture uses a 36" long 4 wire cord. Cord may be field cut.

CONTROL: Gira Sole Mini RGB units are compatible with DMX-512 protocol / color controller.

MOUNTING: (ID) In drywall, fully recessed.

WATTAGE: 7.2W per fixture, single color.

POWER SUPPLY: Remote (external) power supplies are available in 25W, 40W, 60W and 96W. White 240W (3/80W) or 320W (4/80W outputs) power supply. Power consumption may vary based on LED specifications. Please consult factory for proper power supply configuration.

WARRANTY: 5 year warranty, see website for full warranty details.

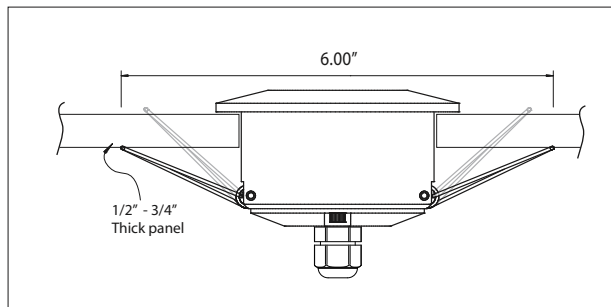
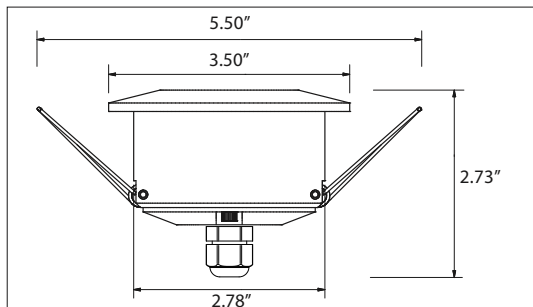

Type: _____

Project: _____

GIRA SOLE MINI

LED | IN-GRADE | WET | IP65



GSMLED

- ❑ **OPTICAL LENS:** Optical grade polycarbonate material provides thermal stability and overall system durability.
- ❑ **DIFFUSER:** Fully gasketed, tempered glass, recessed lens.
- ❑ **BURIAL HOUSING:** Plastic in-grade housing constructed of durable composite material with a water tight Jbox.



APPLICATION: The **GIRA SOLE MINI** in-grade design is perfect for use in landscape applications, walkways, building facades and wall grazing.

CONFIGURATIONS

MODEL	LED/PERFORMANCE	DISTRIBUTION	INPUT*	MOUNTING	FINISH
GSMLED	WT35 (3500K)	NBD (narrow 10°)	120/277V	IG (in-grade)	HAB (hard anodizedblack)
	WT41 (4100K)	MBD (medium 20°)	24VDC		HAT (hard anodizedtitanium)
	WT57 (5700K)				
	SCL ¹ (single color LED)				

HOUSING: Gira Sole Mini is constructed from machined aluminum alloy with anodized or hard anodized finish.

OPTICAL LENS: Cluster design for tight pack uniformity of LEDs. High light collection efficiency rating >85%. Optical grade poly carbonate material provides thermal stability and overall system durability.

DIFFUSER: Fully gasketed, tempered glass, recessed lens. Complete light emission clear optics for increased efficiency and performance.

LED LIGHT ENGINE: High performance white LED available in standard color temperatures 3500K (warm), 4100K (daylight), 5700K (cool). RGB color mixing available in 24VDC only. Single color LED offered contact factory.

CONTROL: Gira Sole Mini RGB units are compatible with DMX-512 protocol / color controller.

MOUNTING: (IG) In-grade with rated thermoplastic housing.

WATTAGE: 7.2W per standard fixture.

POWER LINE/FEED: Single color LED fixture uses a 36" long black two wire cord, and RGB LED fixture uses a 36" long 4 wire cord. Cord may be field cut.

POWER SUPPLY: Remote (external) power supplies are available in 25W, 40W, 60W and 96W. White 240W (3/80W) or 320W (4/80W outputs) power supply.

Power consumption may vary based on LED specifications. Please consult factory for proper power supply configuration.

WARRANTY: 5 year warranty, see website for full warranty details.

