

# NB12Q DuraLED Triangular Low Profile Pathway Bollard, Contemporary Series



<b>Project Information</b>	
Project Name: _____	Fixture Type: _____
Complete Catalog #: _____	Date: _____
Comments: _____	



The DuraLED LED Triangular path light provides full cutoff lighting for outdoor path, walkways and landscape areas using wide spread optics designed to replace outdated Halogen and Compact Fluorescent lighting systems. These fixtures are ideal for landscaped areas at retail centers, restaurants, hotels, schools and universities, office buildings and medical facilities.



## SPECIFICATIONS AND FEATURES:

### HOUSING:

Extruded Aluminum Housing with Flush Mounting Base, Flat Top. Bollard Can Be Cut to Custom Lengths Upon Request.

### LISTING & RATINGS:

CSA: Listed for Wet Locations, ANSI/UL 1598, 8750 IP66 Sealed LED Compartment.

### FINISH:

Textured Architectural Bronze or Black Powdercoat Finish Over a Chromate Conversion Coating. Custom Colors Available Upon Request.

### STYLE:

Specially Designed White Cone Reflector that Minimizes Diode Brightness

### LENS:

Clear UV-Stabilized Polycarbonate or SoftLED LumaLens Opal UV-Stabilized Polycarbonate Vandal-Resistant Lens.

### MOUNTING OPTIONS:

Mounting Kit with 8" Zinc-Plated Anchor Bolts, Included.

### DURALED LED:

Aluminum Boards

### WATTAGE:

Array: 12w. System: 11.8w; (50w HID Equivalent)

### DRIVER:

Electronic Driver, 120-277V, 50/60Hz; Less Than 20% THD and PF>0.90. Standard Internal Surge Protection 2kV. 0-10V Dimming Standard for a Dimming Range of 100% to 10%; Dimming Source Current is 150 Microamps.

### CONTROLS:

Fixtures are NOT Designed for Use with Line Voltage Dimmers.

### WARRANTY:

5-Year Warranty for -40°C to +50°C Environment.

See Page 2 for Projected Lumen Maintenance Table.

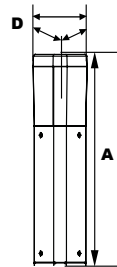

### Dimensions

Length <sup>2</sup> (D)	3½" (90mm)
Height (A)	15" (381mm)

## DuraLED TECHNOLOGY

Complete Units  
Ordering Information  
Example: NB12QF1X12U5KCZ15SP

# NB12Q DuraLED Triangular Low Profile Pathway Bollard Contemporary Series

NB12Q	F	1X12	U					
Model	Optic	Wattage	Driver	CCT	Lens	Color	Height	Options
NB12Q=DuraLED Triangular Low Profile Pathway Bollard, Contemporary Series	F=Wide Beam Spread	1X12=12w	U=120-277V	3K=3000K 4K=4000K 5K=5000K		Z=Bronze B=Black C=Custom (Consult Factory)	15=15" Height C=Custom* (Consult Factory) *15" minimum, taller heights available	SF=Single Fuse* DF=Double Fuse* SP=Surge Protection *120-277V Models Only.

C=Clear UV-Stabilized Polycarbonate Vandal-Resistant Lens  
L=SoftLED LumaLens Opal UV-Stabilized Polycarbonate Vandal-Resistant Lens



Specifications subject to change without notice.

# NB12Q DuraLED Triangular Low Profile Pathway Bollard, Contemporary Series



## PHOTOMETRIC DATA

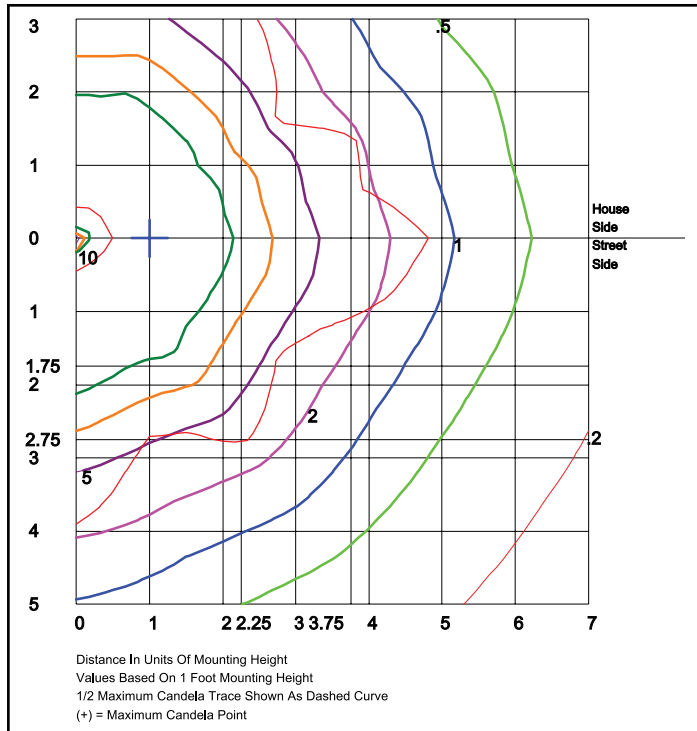

**NB12QF1X12U5KC**  
Type V, Clear Lens  
Grid in feet, Mounting Height = 1 ft.

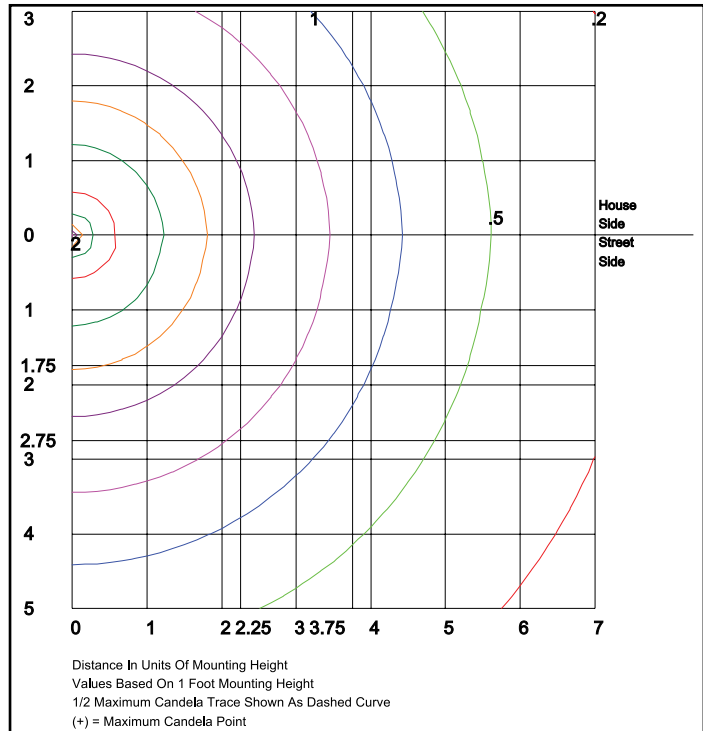

**NB12QF1X12U5KL**  
Type V, LumaLens  
Grid in feet, Mounting Height = 1 ft.

## PHOTOMETRIC PERFORMANCE

Optic	Wattage (Catalog Logic)	12W (1X16)
	Input Watts	11.8W
	CCT	Delivered Lumens
<b>NB12 with Clear Lens</b> F=Type V Optic	3000K	1,221
	4000K	1,271
	5000K	1,320
	BUG Rating	B1-U3-G1
<b>NB12 with LumaLens</b> F=Type V Optic	3000K	780
	4000K	812
	5000K	843
	BUG Rating	B0-U3-G1

## PROJECTED LUMEN MAINTENANCE

Data shown for 5000 CCT		Compare to MH				
TM-21-11	Input Watts	Initial	25,000 Hrs	50,000 Hrs	100,000 Hrs	Calculated LED Life
<b>L70 Lumen Maintenance @ 25°C / 77°F</b>	All wattages up to and including 12w	1.00	0.95	0.90	0.80	147,000
<b>L70 Lumen Maintenance @ 50°C / 122°F</b>		1.00	0.89	0.78	0.55	67,000
<b>L80 Lumen Maintenance @ 40°C / 104°F</b>		1.00	0.92	0.85	0.70	66,000

- NOTES:**  
 1. Projected per IESNA TM-21-11. Data references the extrapolated performance projections for the base model in a 25°C ambient, based on 10,000 hours of LED testing per IESNA LM-80-08.  
 2. Compare to MH box indicates suggested Light Loss Factor (LLF) to be used when comparing to Metal Halide (MH) systems.