

# HB30C3 Astra Low Profile 16" COB LED Highbay



<b>Project Information</b>	
Project Name: _____	Fixture Type: _____
Complete Catalog #: _____	Date: _____
Comments: _____	

The DuraGuard Astra Low Profile 16" COB LED Highbay is available with a choice of four lenses designed to replace HID lighting systems up to 400w MH. Typical high bay lighting applications include warehouses, manufacturing facilities, gymnasiums, indoor sports facilities, and retail and big box store lighting. Suitable for 10 to 30 foot mounting heights based on light level and uniformity requirements.

**SPECIFICATIONS AND FEATURES:**

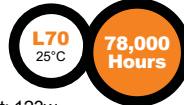

**HOUSING:**

Die Cast Aluminum Housing with External Heat Sinks for Cooler Operating Temperatures. Externally Mounted Driver.

**LISTING & RATINGS:**

CSA: Listed for Dry Locations, ANSI/UL 1598, 8750 IP65 (with Lenses); IP44 (Open)

**FINISH:**

White Powdercoat Finish Over a Chromate Conversion Coating. Custom Colors Available Upon Request.

**LENS:**

Can Be Used Without Lens or with Tempered Clear Flat Glass Lens, Acrylic Drop Lens, Acrylic Conical Lens, UV-Stabilized Polycarbonate Drop Lens

**MOUNTING OPTIONS:**

Mount with Included 3/4" Die Cast Hook. Adjustable Junction Box Also Accepts 3/4" Conduit.

**COB LED:**

DuraGuard COB

**WATTAGE:**

120w: COB: 120w; System Input: 123w (250w HID Equivalent)  
200w: COB: 200w; System Input: 197w (400w HID Equivalent)

**DRIVER:**

Electronic Driver, 120-277V, 50/60Hz or 347-480V, 50/60Hz (200w Model Only); Less Than 20% THD and PF>0.90. Standard Internal Surge Protection 6kV. 0-10V Dimming Standard for a Dimming Range of 100% to 10%; Dimming Source Current is 150 Microamps.

**CONTROLS:**

Fixtures Ordered with Factory-Installed Photocell or Motion Sensor Controls are Internally Wired for Switching and/or 1-10V Dimming Within the Housing. Remote Direct Wired Interface of 1-10V Dimming is Not Implied and May Not Be Available, Please Consult Factory. Fixtures are Tested with DuraGuard Controls and May Not Function Properly With Controls Supplied by Others. Fixtures are NOT Designed for Use with Line Voltage Dimmers.

**WARRANTY:**

5-Year Warranty for -40°C to +50°C Environment.

See Page 4 for Projected Lumen Maintenance Table



**Microwave Sensor Factory Installed "M3" Option (120-277V Only)**

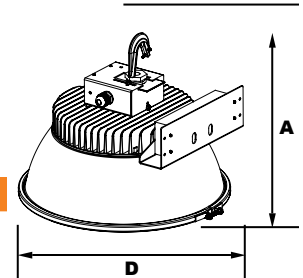

**Dimensions**

<b>Diameter (D)</b>	16 1/4" (413mm)
<b>Height (A)</b>	13 1/4" (338mm)

**DuraLED TECHNOLOGY**

Complete Units  
Ordering Information  
Example: HB30C310X20U5KGWSP

## HB30C3 Astra Low Profile 16" COB LED Highbay

HB30C3		5K				
Model	Wattage	Driver	CCT	Lens	Color	Options
HB30C3 = Astra Low Profile 16" COB LED Highbay	6X20=120w 10X20=200w	U=120-277V H=347-480V* *200w Model Only	5K=5000K		W=White C=Custom (Consult Factory)	
				<b>N</b> =No Lens <b>G</b> =Clear Flat Glass Lens <b>C</b> =Acrylic Conical Lens <b>D</b> =Acrylic Drop Lens <b>B</b> =UV-Stabilized Polycarbonate Drop Lens		
				<b>SF</b> =Single Fuse* <b>DF</b> =Double Fuse* <b>SP</b> =Surge Protection <b>M3</b> = Microwave Sensor for Mounting Heights of 20 Feet or Above* <b>CP6120W</b> =6' White Cord, 3 Wire, L5-15P Twist-Lock Plug <b>CP6277W</b> =6' White Cord, 3 Wire, L7-15P Twist-Lock Plug <b>C6600B</b> =6' Black Cord, STW, 600VAC, 3 Wire, Leads <b>C6600W</b> =6' White Cord, STW, 600VAC, 3 Wire, Leads <b>C4600B</b> =4' Black Cord, SEOW, 600VAC, 3 Wire, Leads		

\*120-277V Models Only.



Specifications subject to change without notice.

# HB30C3 Astra Low Profile 16" COB LED Highbay



## Lens Options



**HB30C3 Shown with Tempered Clear Flat Glass Lens (G)**



**HB30C3 Shown with Acrylic Drop Lens (D)**



**HB30C3 Shown with UV-Stabilized Polycarbonate Drop Lens (B)**



**HB30C3 Shown with Acrylic Conical Lens (C)**

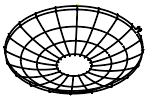

**HBAR16WG**



**P17116**

Accessories (Order Separately, Field Installed)	
HBAR16WG	Wire Guard, 16" for Use with Flat Glass Lenses.

Replacement Parts (Order Separately, Field Installed)	
16ACDL	16" LexaLite Clear Prismatic Acrylic Drop Lens. UV-Stabilized, High-Efficiency Operation in General Applications.
16PCDL	16" UV-Stabilized Polycarbonate Drop Lens
16ACCL	16" LexaLite Clear Prismatic Acrylic Conical Lens. UV-Stabilized, High-Efficiency Operation in General Applications.
16FG	16" Tempered Clear Flat Glass Lens
16CB	16" Clampband
CPMH1	Die Cast Hook with 3/4" NPS Threads
P17116	Microwave Sensor for Mounting Heights of 20 Feet or Above*.

Specifications subject to change without notice.

# HB30C3 Astra Low Profile 16" COB LED Highway



**PHOTOMETRIC DATA**

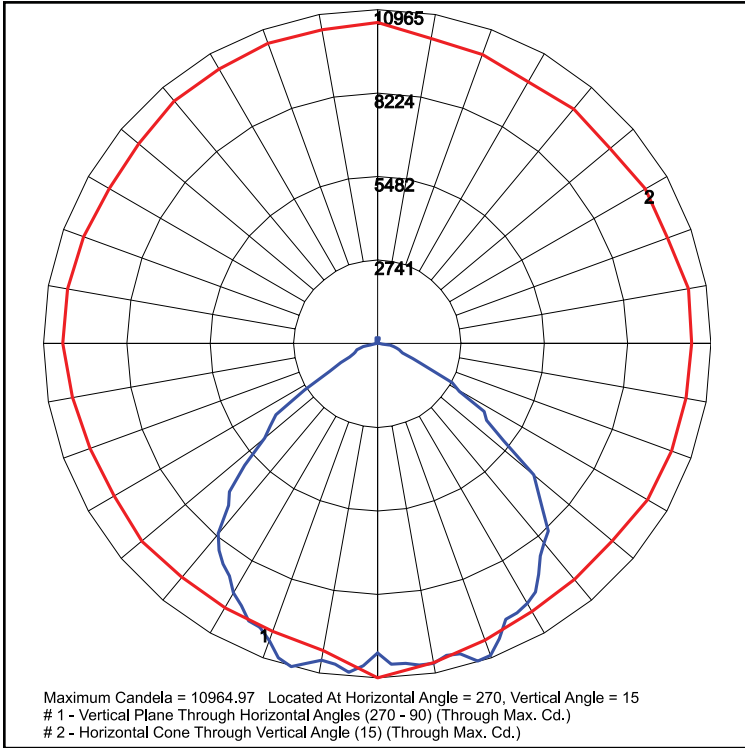

**HB30C310X20U5KG - Clear Glass Lens**

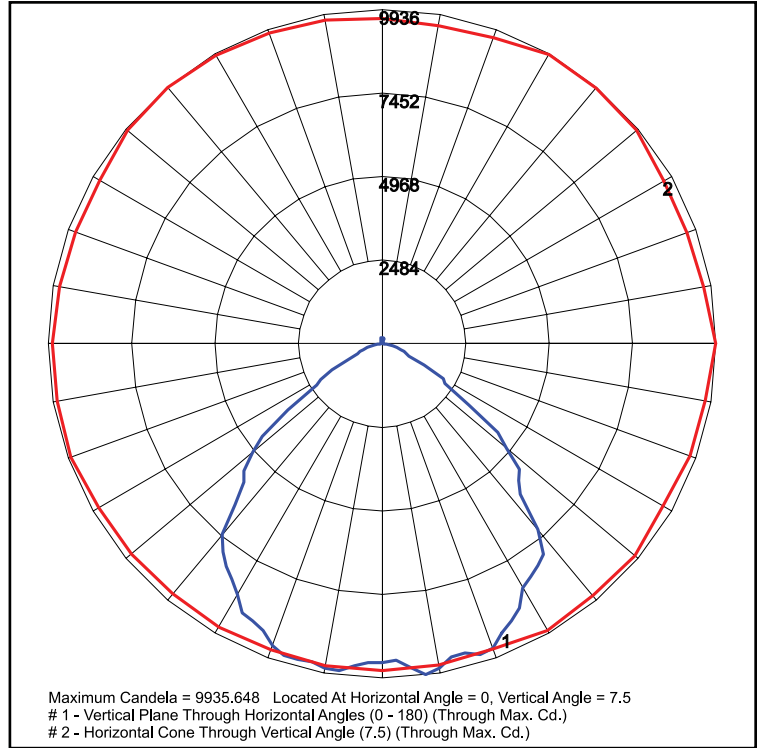

**HB30C310X20U5KG - Clear Glass Lens**

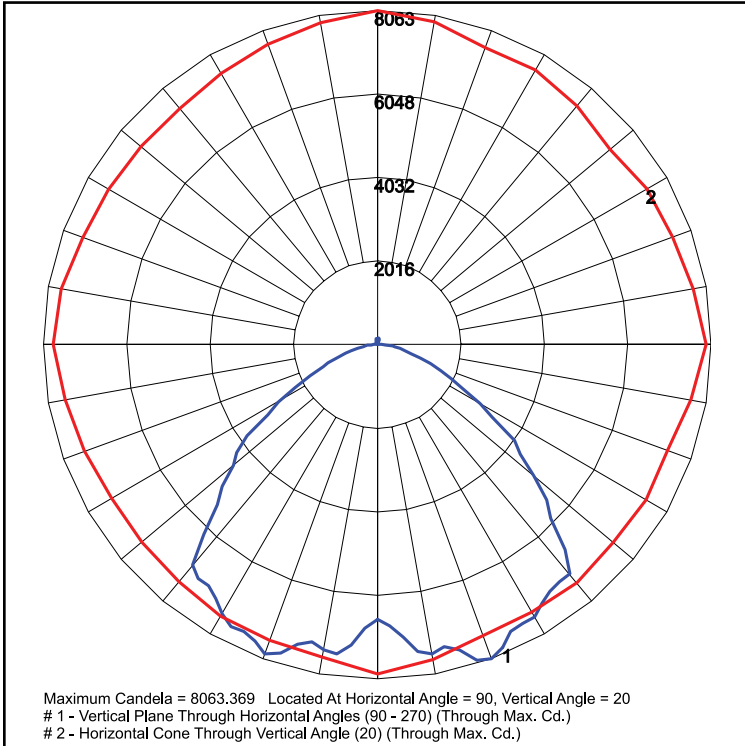

**HB30C310X20U5KC - Acrylic Conical Lens**

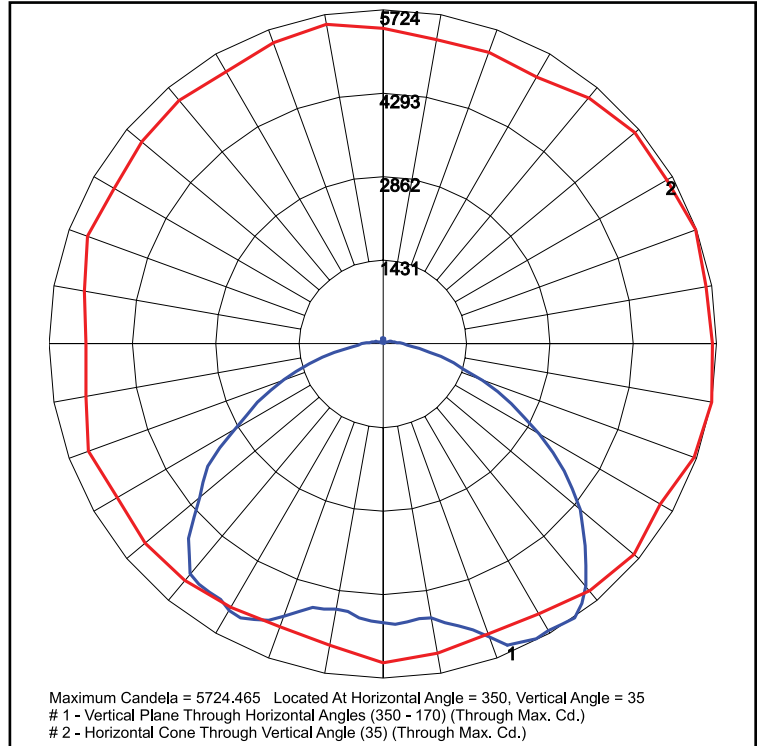

**HB30C310X20U5KD - Acrylic Drop Lens**

Specifications subject to change without notice.

**HB30C3 Astra Low Profile 16" COB LED Highbay****DuraGuard**  
PRODUCTS INC.  
A QSSI Company**PHOTOMETRIC PERFORMANCE**

LED Board Watts	Drive Current (mA)	Input Watts	Spacing Criteria	5000 CCT 80 CRI	
				Lumens	LPW
COB LED 120w with No Lens (N)	525	123	1.32	15,184	123
COB LED 120w with Clear Glass (G)			1.34	13,809	112
COB LED 120w with Acrylic Conical Lens (C)			1.58	13,136	107
COB LED 120w with Acrylic Drop Lens (D)			1.70	11,689	95
COB LED 200w with No Lens (N)		197	1.32	25,306	128
COB LED 200w with Clear Glass (G)			1.34	22,349	113
COB LED 200w with Acrylic Conical Lens (C)			1.58	21,893	111
COB LED 200w with Acrylic Drop Lens (D)			1.70	19,482	99

**PROJECTED LUMEN MAINTENANCE**

Data shown for 5000 CCT		Compare to MH				
TM-21-11	Input Watts	Initial	25,000 Hrs	50,000 Hrs	100,000 Hrs	Calculated LED Life
L70 Lumen Maintenance @ 25°C / 77°F	All wattages up to and including 197w	1.00	0.90	0.81	0.62	78,000
L70 Lumen Maintenance @ 50°C / 122°F		1.00	0.87	0.73	0.46	56,000
L80 Lumen Maintenance @ 40°C / 104°F		1.00	0.88	0.77	0.53	43,000

**NOTES:**

1. Projected per IESNA TM-21-11. Data references the extrapolated performance projections for the 525mA base model in a 25°C ambient, based on 10,000 hours of LED testing per IESNA LM-80-08.
2. Compare to MH box indicates suggested Light Loss Factor (LLF) to be used when comparing to Metal Halide (MH) systems.