

# DuraLED Round & Square Pillar Tops



Project Name:	<b>Project Information</b>	Fixture Type:
Complete Catalog #:		Date:
Comments:		

The DuraGuard DuraLED Pillar Top luminaires with UV-stabilized polycarbonate lenses and sealed optical compartments are designed to replace HID lighting systems up to 70w MH or HPS. These fixtures are designed for use on pillars, columns, fences, railings and other outdoor structures. Ideal for use in retail centers, schools and universities, office buildings, apartments and condominium complexes, and residential areas.

### SPECIFICATIONS AND FEATURES:

#### HOUSING:

Die Cast Aluminum Housing with Flush Mounting Base, Flat, Dome and Pyramid Top, Internal Driver Tray for Easy Maintenance. 1/2" Coin Plugs for Conduit Entry.

#### LISTING & RATINGS:

CSA: Listed for Wet Locations, ANSI/UL 1598, 8750 IP66 Sealed LED Compartment.

#### FINISH:

Textured Architectural Bronze or Black Powdercoat Finish Over a Chromate Conversion Coating. Custom Colors Available Upon Request.

#### REFLECTOR:

Reflective White UV-Stabilized Polycarbonate Cone Reflector

#### LENS:

Clear UV-Stabilized Polycarbonate or SoftLED LumaLens Opal UV-Stabilized Polycarbonate Vandal-Resistant Lens.

#### MOUNTING:

Flush Mount on Flat Surfaces. Cast-In Electrical Box Template with 1/2" Coin Plug on Bottom.

**DURALED LED:**  
Aluminum Boards

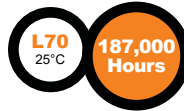

#### WATTAGE:

Array: 16w, System: 17.7w (up to 70w HID equivalent)  
Array: 23w, System: 24.8w (up to 70w HID equivalent)  
Array: 34w, System: 37.2w (up to 70w HID equivalent)

#### DRIVER:

Electronic Driver, 120-277V, 50/60Hz or 347V, 50/60Hz; Less Than 20% THD and PF>0.90. Standard Internal Surge Protection 2kV. 0-10V Dimming Standard for a Dimming Range of 100% to 10%; Dimming Source Current is 150 Microamps.

#### WARRANTY:

5-Year Warranty for -20°C to +40°C Environment.

See Page 3 for Projected Lumen Maintenance Table.

## DuraLED TECHNOLOGY



**B1PTQ**  
Round Flat  
Pillar Top



**B1BPTQ**  
Round Dome  
Pillar Top



**B2CPTQ**  
Square Pyramid  
Pillar Top



**B2PTQ**  
Square Flat  
Pillar Top

### Dimensions

<b>Diameter (D1)</b>	9 1/4" (233mm)
<b>Diameter (D2)</b>	7" (178mm)
<b>Height (A1)</b>	6 1/4" (159mm)
<b>Height (A2)</b>	8 3/4" (219mm)

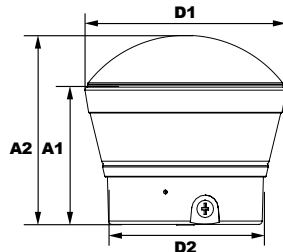

### Dimensions

<b>Length<sup>2</sup> (L1)</b>	9 1/4" (236mm)
<b>Length<sup>2</sup> (L2)</b>	7" (178mm)
<b>Height (A1)</b>	6 3/4" (162mm)
<b>Height (A1)</b>	8 3/4" (222mm)

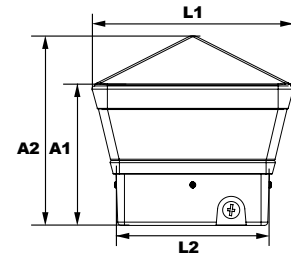

Complete Units Ordering Information  
Example: **B1PTQF1X34U4KCZSF**

## DuraLED Round & Square Pillar Tops

Model	Optics	Wattage	Driver	CCT	Lens	Color	Options
	<b>F</b> =Wide Beam Spread	<b>1X16</b> =16w <b>1X23</b> =23w <b>1X34</b> =34w	<b>U</b> =120-277V <b>C</b> =347V* <b>H</b> =347-480V+  *23w Model Only *34w Model Only	<b>3K</b> =3000K* <b>4K</b> =4000K  *Square Models Only		<b>Z</b> =Bronze <b>B</b> =Black <b>C</b> =Custom (Consult Factory)	<b>SF</b> =Single Fuse* <b>DF</b> =Double Fuse* <b>SP</b> =Surge Protection  *120-277V Models Only.
<b>B1PTQ</b> =Round Flat Pillar Top <b>B1BPTQ</b> =Round Dome Pillar Top <b>B2PTQ</b> =Square Flat Pillar Top <b>B2CPTQ</b> =Square Pyramid Pillar Top							
<b>C</b> =Clear UV-Stabilized Polycarbonate Vandal-Resistant Lens <b>L</b> =SoftLED LumaLens Opal UV-Stabilized Polycarbonate Vandal-Resistant Lens							



Specifications subject to change without notice.

# DuraLED Round & Square Pillar Tops



## PHOTOMETRIC DATA

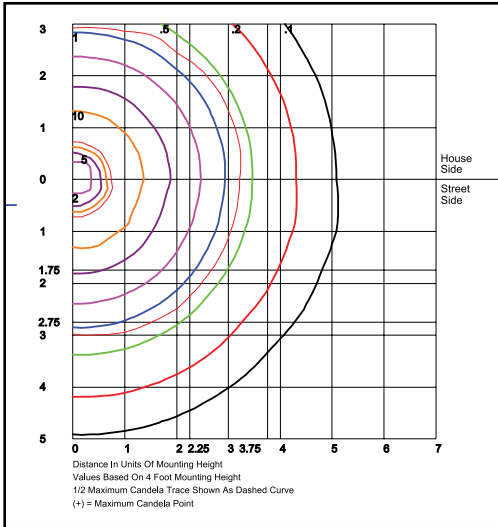

**B1PTQF1X34U4KC & B1BPTQF1X34U4KC**  
**Type V, Clear Lens**  
 Grid in feet, Mounting Height = 4 ft.

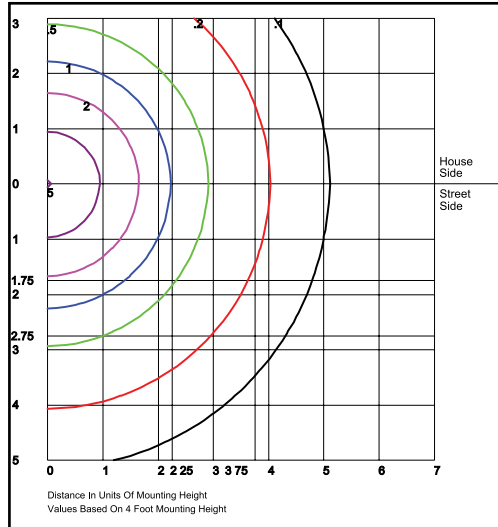

**B1PTQF1X34U4KL & B1BPTQF1X34U4KL**  
**Type V, LumaLens**  
 Grid in feet, Mounting Height = 4 ft.

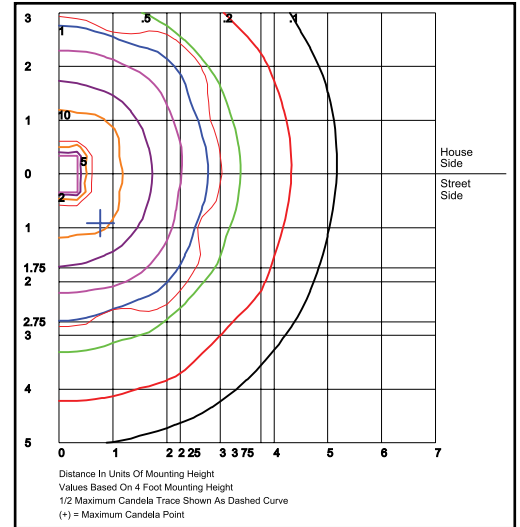

**B2PTQF1X34U4KC & B2CPTQF1X34U4KC**  
**Type V, Clear Lens**  
 Grid in feet, Mounting Height = 4 ft.

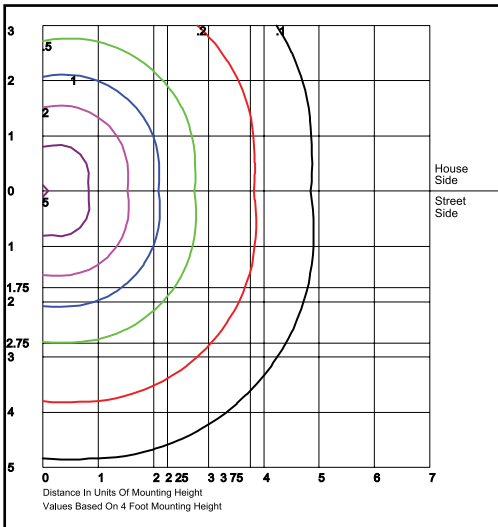

**B2PTQF1X34U4KL & B2CPTQF1X34U4KL**  
**Type V, LumaLens**  
 Grid in feet, Mounting Height = 4 ft.

# DuraLED Round & Square Pillar Tops



## PHOTOMETRIC PERFORMANCE

Optic	CCT	Delivered Lumens		
		16W (1X16)	23W (1X23)	34W (1X34)
<b>Wattage (Catalog Logic)</b>		<b>16W (1X16)</b>	<b>23W (1X23)</b>	<b>34W (1X34)</b>
<b>Input Watts</b>		<b>17.7W</b>	<b>24.8W</b>	<b>37.2W</b>
<b>B1PT Clear Polycarbonate F=Type V Optic</b>	3000K	-	-	-
	4000K	1,525	2,135	3,202
	5000K	-	-	-
	BUG Rating	B1-U3-G1	B1-U3-G1	B1-U3-G1
<b>B1PT LumaLens F=Type V Optic</b>	3000K	-	-	-
	4000K	975	1,365	2,047
	5000K	-	-	-
	BUG Rating	B1-U3-G1	B1-U3-G1	B1-U4-G2

Optic	CCT	Delivered Lumens		
		16W (1X16)	23W (1X23)	34W (1X34)
<b>Wattage (Catalog Logic)</b>		<b>16W (1X16)</b>	<b>23W (1X23)</b>	<b>34W (1X34)</b>
<b>Input Watts</b>		<b>17.7W</b>	<b>24.8W</b>	<b>37.2W</b>
<b>B2PT Clear Polycarbonate F=Type V Optic</b>	3000K	1,432	2,005	3,008
	4000K	1,554	2,175	3,263
	5000K	-	-	-
	BUG Rating	B1-U3-G1	B1-U3-G1	B1-U4-G1
<b>B2PT LumaLens F=Type V Optic</b>	3000K	864	1,210	1,816
	4000K	938	1,313	1,969
	5000K	-	-	-
	BUG Rating	B0-U3-G1	B1-U3-G1	B1-U4-G2

## PROJECTED LUMEN MAINTENANCE

Data shown for 4000 CCT TM-21-11	Input Watts	Compare to MH				Calculated L70@ 25°C
		Initial	25,000 Hrs	50,000 Hrs	100,000 Hrs	
<b>B1PT/B2PT L70 Lumen Maintenance @ 25°C / 77°F</b>	All wattages up to and including 34w	1.00	0.96	0.92	0.84	187,000
<b>B1PT/B2PT L70 Lumen Maintenance @ 50°C / 122°F</b>		1.00	0.93	0.87	0.73	113,000
<b>B1PT/B2PT L80 Lumen Maintenance @ 40°C / 104°F</b>		1.00	0.97	0.93	0.86	144,000

**NOTES:**

1. Projected per IESNA TM-21-11. Data references the extrapolated performance projections for the base model in a 25°C ambient, based on 10,000 hours of LED testing per IESNA LM-80-08.
2. Compare to MH box indicates suggested Light Loss Factor (LLF) to be used when comparing to Metal Halide (MH) systems.